

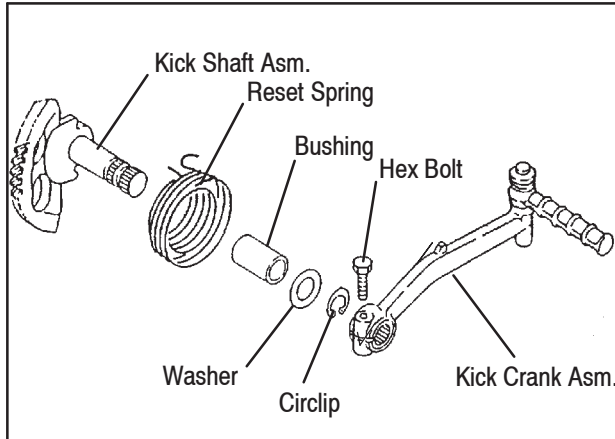

KICK START ASSEMBLY

NOTE: This procedure is used to re-wind the kick start spring if the spring or any related components are disassembled for service. **It is not necessary to remove the kick start lever or kick drive components to remove the engine cover.**



1. Secure cover lightly in a vise as shown. Protect the surface of the cover with a shop towel.

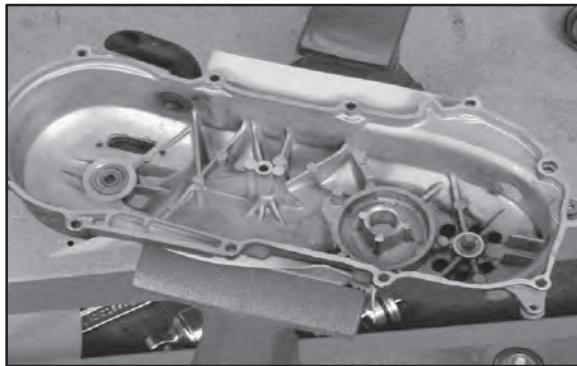

2. Install the spring as shown with the hook (A) positioned on post. Note the spring tab (B). The tab must be pre-wound approximately 5/8 turn (about 225 degrees) to point C in order to install the kick shaft/gear assembly.

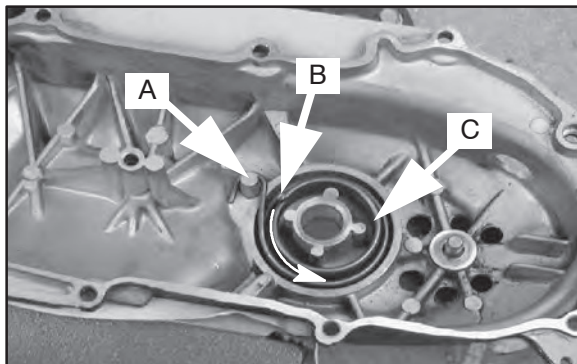

3. Grease and install the bushing in the kick shaft boss.

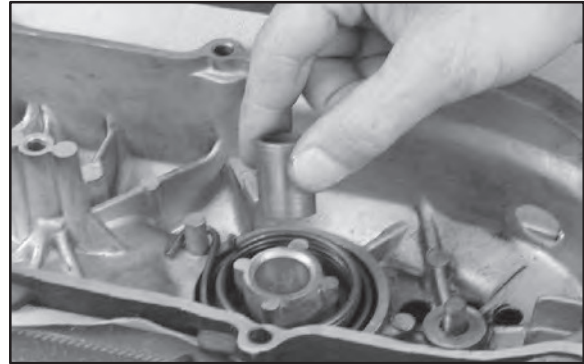

4. Install the kick shaft as shown, with the edge of the gear resting on the spring hook post (A). Grasp the spring firmly with duckbill or needle nose pliers between the inner and outer spring coils. Wind the spring approximately 225 degrees clockwise, while also rotating the gear counter-clockwise into final position.

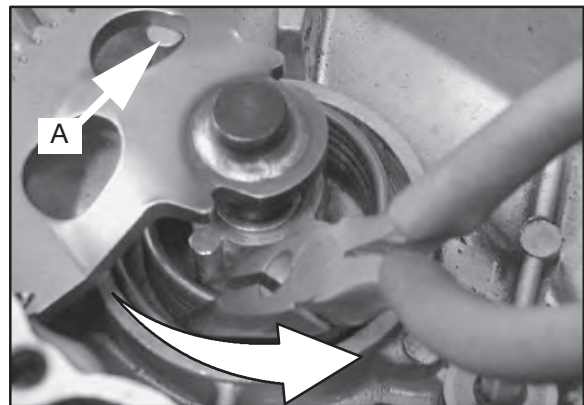

5. Push the shaft/gear assembly in and release the spring. The tab should be located against the edge of the gear as shown (A).

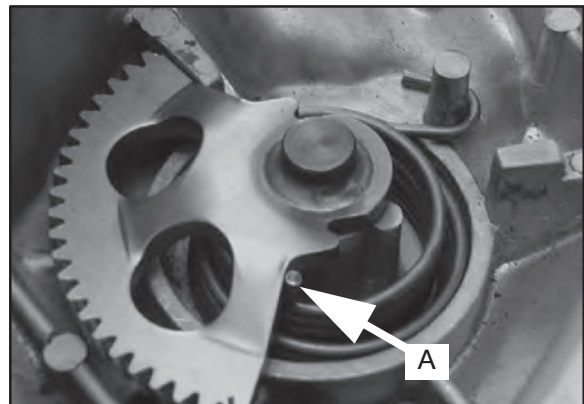



6. Release the cover from the vise. Turn the cover over while holding the spring and shaft assembly in place, and install the washer.



7. Install the snap ring.

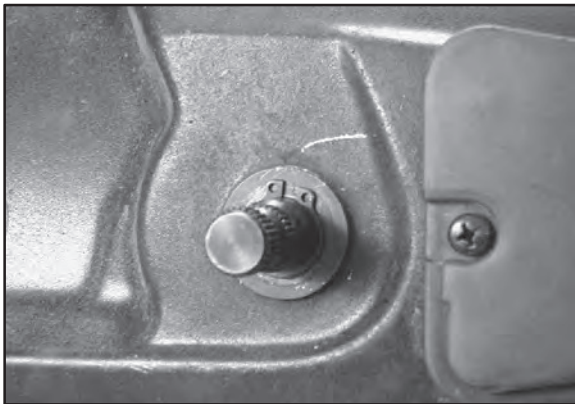

8. Install the kick pinion with the end of the drag spring (A) engaged in the slot (B).

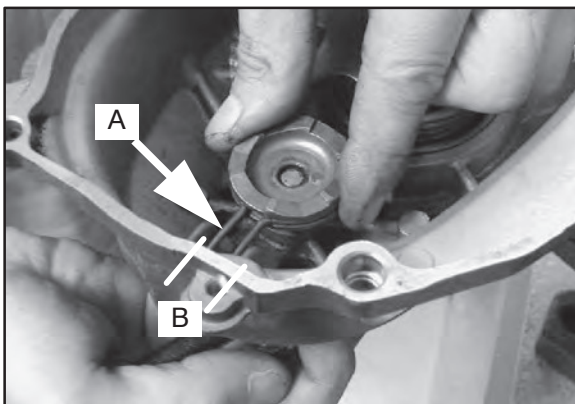

STARTER DRIVE ONE-WAY INSPECTION

NOTE: Use caution when disassembling the starter wheel, the one-way clutch assembly contains springs and pins that easily come out of place. Upon assembly, do not lubricate the one way rollers with heavy grease, as this will cause the one-way drive to malfunction.

1. Remove the CVT cover, belt and drive clutch components to gain access to the one-way drive.
2. Remove the idle gear plate, two washers, and idle gear from the pin shaft.

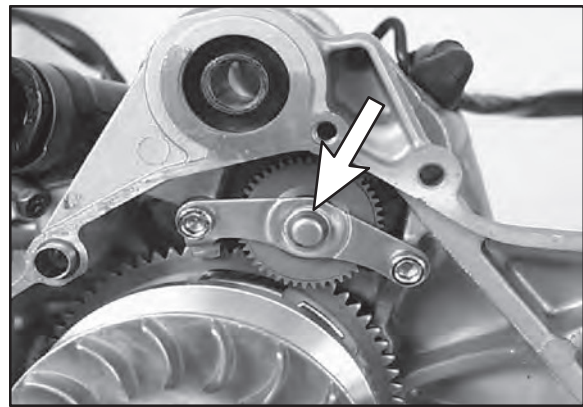

NOTE: There is one washer on the inside of the idle gear and one washer on the outside of the idle gear.

3. Remove the washer and needle bearing. Carefully remove the starter wheel from the crankshaft.

